

MODULAR CHARGE DESKS

Fleetwood charge desks are fully modular allowing you to combine any of the modules shown here. Create a unique charge desk to meet your specific needs. Start small this year and add modules as your budget allows. Change out a module later, or reconfigure those you have, when your needs change.

Here are the main charge desk choices you will make:

- Upper ledge height: 32" high or 39" high (32" typically for elementary level)
- Standard Ledge (3" deep") or a Patron Ledge (8" deep). The upper ledge height is higher than the work surface. You will need to choose one for some modules.
- Straight versus rounded corner units

All of the modules shown here come in either the 32" or 39" high versions. Those modules offering either the Standard or Patron Ledge have two numbers. The first number for the Standard Ledge; the second number for the Patron Ledge. Desk work surfaces are all 29" high.

Modules



Finishing End Panel
80.013
(must order two per system)

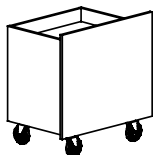

Depressible Book Truck
80.0233
(works with book return and
foyer book return units)
80.0228

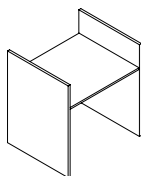

**ADA Book
Check Out Station**
80.033

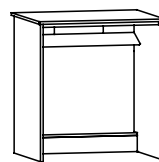

Book Return Unit
80.043
(depressible book truck
sold separately)



Foyer Book Return
83.0442
(depressible book truck
sold separately)

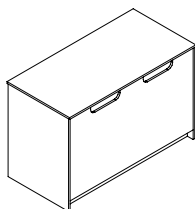

**Double Book/
Media Return**
80.053

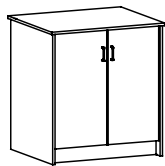

**Storage Cabinet
with Two Shelves**
80.063

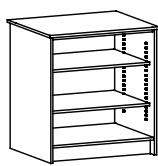

Open Storage Unit
80.083

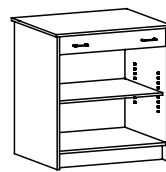

**Storage Unit with
Drawer without Doors**
80.103

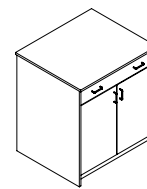

**Storage Unit with
Drawer and Doors**
80.113

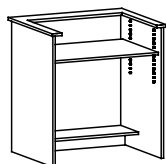

Work Station
80.143
80.633

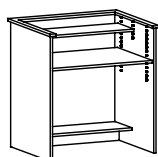

**Work Station
with Shelf**
80.163

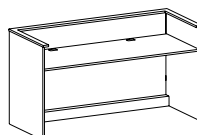

Work Station
80.153
80.643

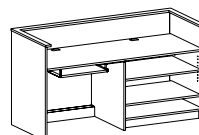

**Work Station with
Open Storage**
80.443
80.653

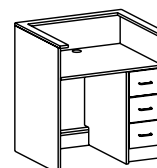

**Work Station with
Right Hand Pedestal**
80.463
80.663

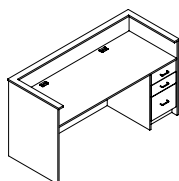

**Work Station with
Right Hand Pedestal**
80.473
80.673

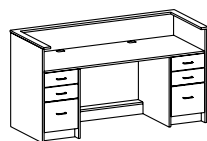

**Work Station with
Double Pedestal**
80.483
80.683

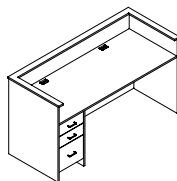

**Work Station with
Left Hand Pedestal**
80.493
80.693

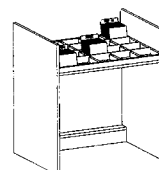

CD Display
80.833
(holds approx. 100 CDs)