

PERSPECTIVE VIEW

**CTE.FAC.CMB.01**

CTE.Facilitate.Combination.#1

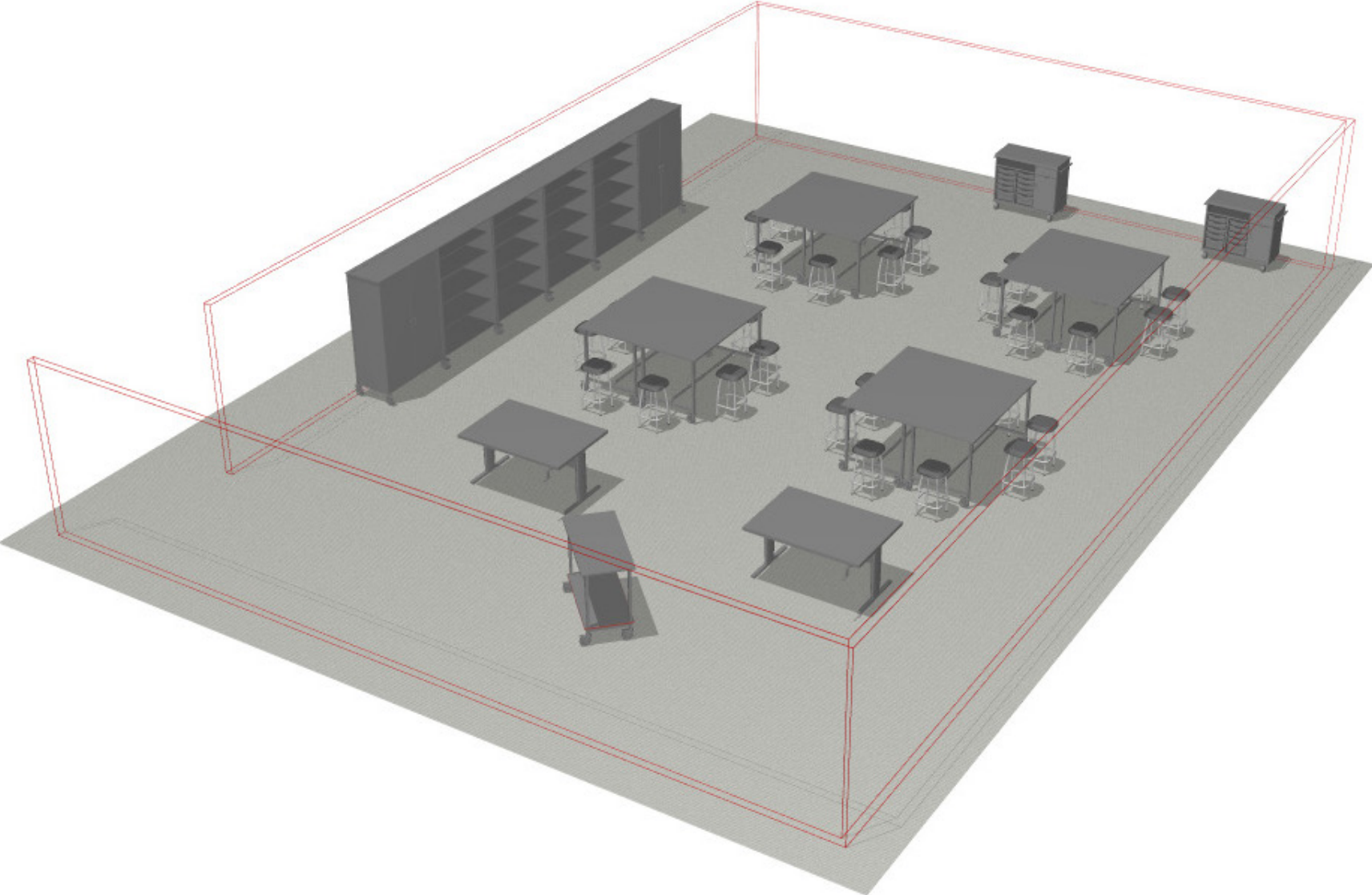

Fleetwood®

For help creating your effective learning environment,  
contact us at 616.396.1142 or [sales@fleetwoodfurniture.com](mailto:sales@fleetwoodfurniture.com)

# PLAN VIEW

## CTE.FAC.CMB.01

CTE.Facilitate.Combination.#1

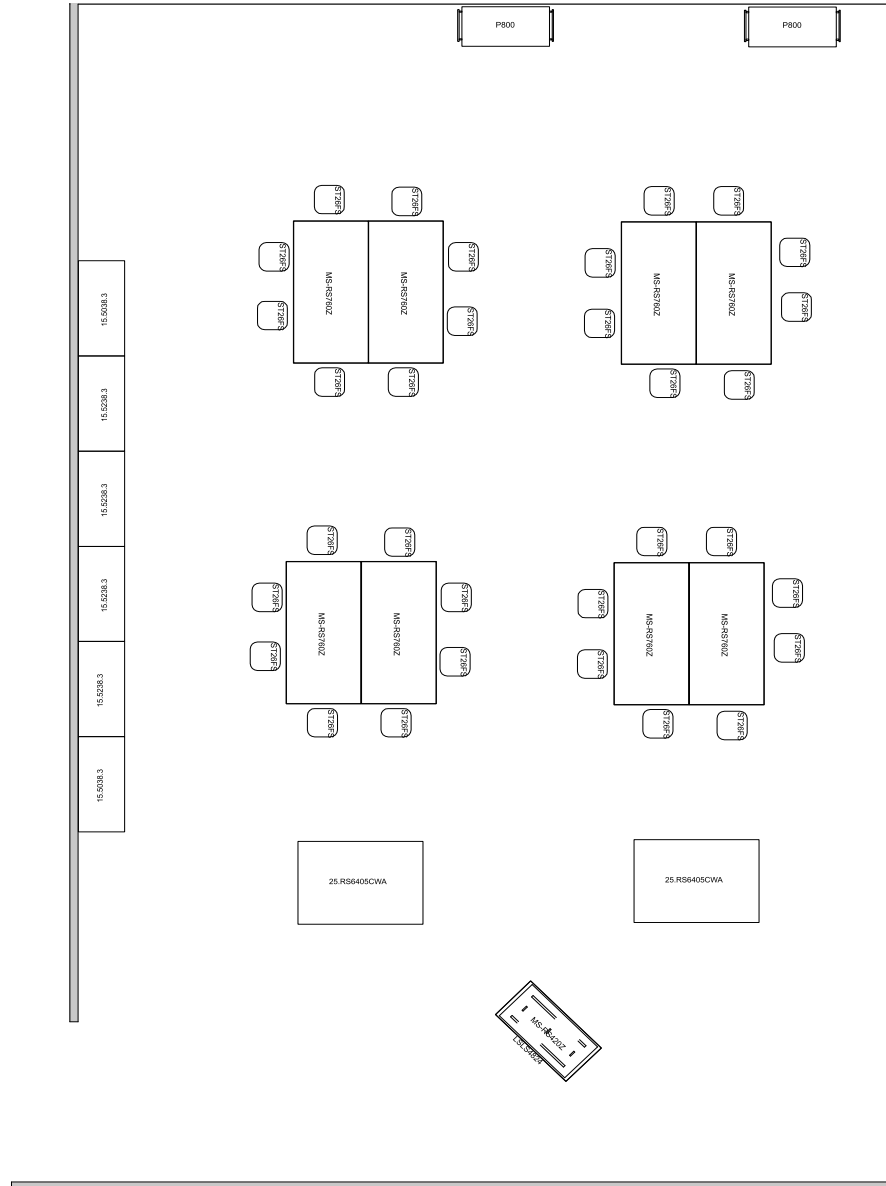

# PRODUCT LIST

## CTE.FAC.CMB.01

CTE.Facilitate.Combination.#1

PART NUMBER	DESCRIPTION	QTY	LIST	EXT. SELL
ST26FS	Dark Graphite Seat 13.5w 26h 13.5d	32	\$460	\$14,720
15-5038-3	Tall 4 Shelf Lckg Drs 2 Lckg/2 Non-Lckg Cstrs 48w 72h 22d	2	\$2,080	\$4,160
15-5238-3	Tall 4 Shelf No Drs 2 Lckg/2 Non-Lckg Cstrs 48w 72h 22d	4	\$1,680	\$6,720
25-RS6405BW	Adj Ht Glides 60w 26-37h 42d	2	\$3,052	\$6,104
LSLS4824	Lower Storage Shelf Laminate Shelf Installed at the factory . Shelf color is Etched Gray	1	\$232	\$232
MS-RS420Z	Rectangle Table, Unitized Frame, Square Legs, Specialty Worksurface Material Adjustable Height H-Leg with Foot Rail 5"Casters 48w 34-42h 24d	1	\$854	\$854
MS-RS760Z	Rectangle Table, Unitized Frame, Square Legs, Specialty Worksurface Material Adjustable Height H-Leg with Foot Rail 5"Casters 72w 34-42h 36d	8	\$1,138	\$9,104
P800	Project Cart Lckg Dr /Drw Cstrs 42w 36. 75h 20d	2	\$2,930	\$5,860

Total FLEETWOOD - \$47,754.00

# RENDERING

## CTE.FAC.CMB.01

CTE.Facilitate.Combination.#1

