

Base & Wall Hung Filler Assembly Instructions

937610-INST
Rev. B

- 1.** If necessary, cut backsplash, top, front, bottom and toe kick to size. (Not all parts are included in each filler product.)

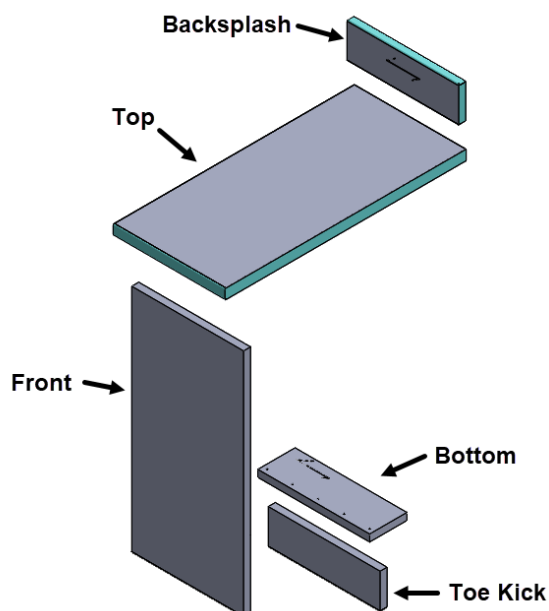

- 2.** Attach angle brackets to front, toe kick and top with #10 x .625" screws. Tighten to a torque of 30-35 in-lbs.

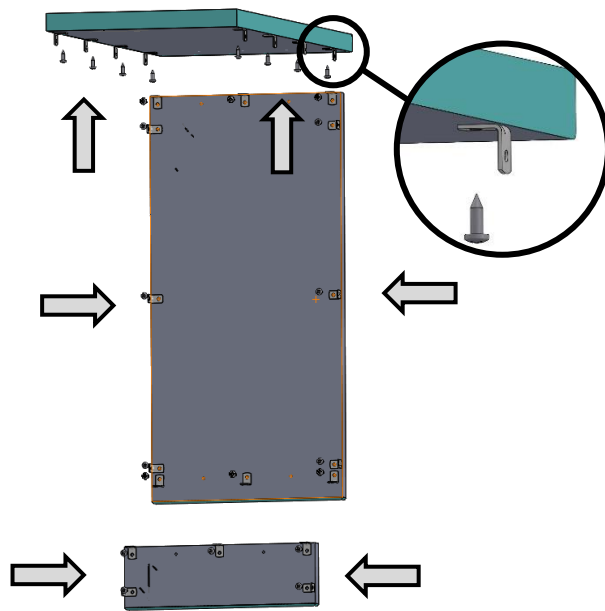

- 3.** Attach the front to the bottom and top and attach the toe kick to the bottom with #10 x .625" screws. Tighten to a torque of 30-35 in-lbs.

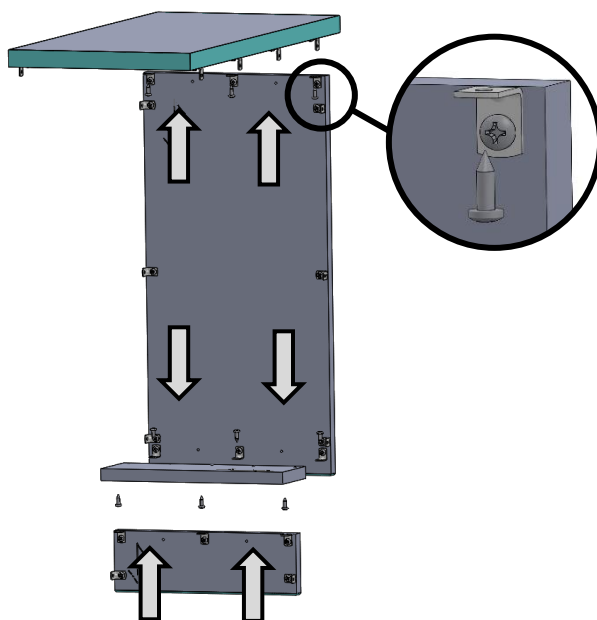

- 4.** Attach assembled filler and backsplash to adjacent cabinet using #10 x .625" screws and brackets attached to filler. Tighten to a torque of 30-35 in-lbs.

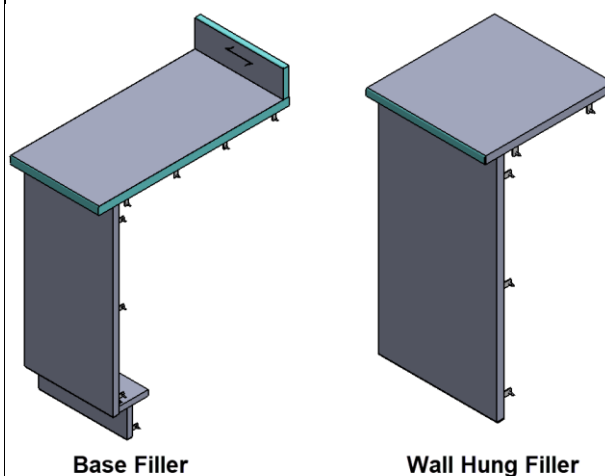

For questions please call us at (616) 396-1142