

DESKS & TABLES

UNITIZED WELDED FRAME

Fleetwood's signature Unitized Welded Frame desks are the industry leaders for individual or two-student desks. Strength, durability, mobility options, clean aesthetics, and under-worksurface storage options are unparalleled. Our Unitized Welded Frame tables are perfect for group use, sitting and standing applications, fixed, and mobile purposes. Tailor them to meet your needs.

WORKSURFACE

- 1" thick worksurfaces except for Maple Block
- HPL (standard)
- Chemical Resistant HPL
- Phenolic Resin (available on select shapes)
- Solid Maple Block (1-3/4" thick)
(available on rectangle shape)
- Rectangle shape with square corners
- Other shapes with rounded corners

FRAME AND LEGS

- Legs are fully welded to frame under worksurface
- DESKS: Worksurface perimeter frame is 3-sided on tops 36" wide x 30" deep or less, excluding 30" wide x 30" deep
- 2 STUDENT DESKS: Worksurface perimeter frame is 3-sided on all sizes
- TABLES: Worksurface perimeter frame is 4-sided on tops 30" wide x 30" deep, 36" wide x 36" deep, and 48" wide-72" wide
- Square or round tube legs for rectangular tops
- Square tube legs for rectangular computer tops
- Round tube legs for plane and other shaped tops
- See ADJUSTABLE HEIGHT for other features

MOBILITY

- 1.5" diameter levelers - all legs (HPL or Chemical Resistant HPL worksurface material)
- 2" diameter levelers - all legs (square legs with phenolic resin or maple block worksurface material)
- Wheelbarrow - 75mm casters and 1.5" diameter levelers (HPL or Chemical Resistant HPL worksurface material and desk/table size 72" wide x 24" deep or smaller)
- 75mm casters - all locking
- 5" casters - All locking (square leg only)

SHIPPING

- Worksurfaces ship stacked, separate from frame/leg assembly, unless table is specified assembled or maple block worksurface material is ordered.
- Frame/leg assemblies ship stacked, unless table is specified assembled or maple block worksurface material is ordered.
- Levelers or caster stems installed on legs
- Casters field installed

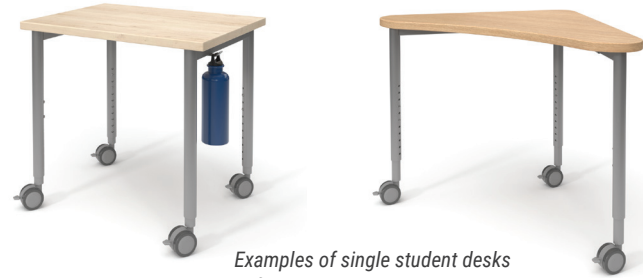

Examples of single student desks
Left image: Shown with accessory hook



Example of two student desk
with gratnells tray accessory

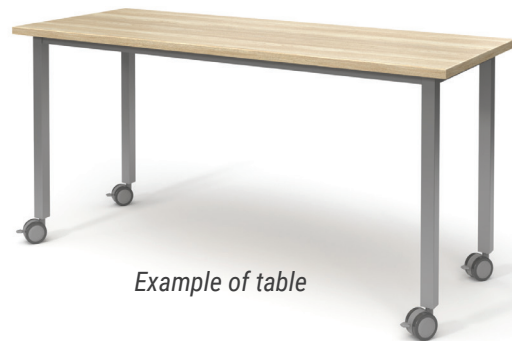

Example of table

DESKS & TABLES

UNITIZED WELDED FRAME



FIXED HEIGHT

- 29" high



ADJUSTABLE HEIGHT

- 20"-28" high
- 24"-32" high

KEY FEATURES

No side or foot rail bar standard on:

- 20"-28" high - no visible adjustment holes between 20"-23" heights
- 24"-32" high - no visible adjustment holes
- 1" height adjustment increments
- Tamper resistant, dual height adjustment system



ADJUSTABLE HEIGHT WITH SIDE RAILS

- 29"-42" high

KEY FEATURES

Side rail bar standard on:

- Adjustment holes may be visible below 34" height
- 29"-42" - Potential visible adjustment holes between
- For 29-42h Side rail bar is 8.5" above the floor
- 1" height adjustment increments
- Tamper resistant, dual height adjustment system



ADJUSTABLE HEIGHT WITH SIDE AND FOOT RAILS

- 29"-42" high (with 36", 42", or 48" deep worksurface).
- 34"-42" high (All worksurface depths)

KEY FEATURES

- Side rail & foot rail are 8.5" above the floor
- Foot rail bar is centered between legs
- Foot rail diameter is 1.25"
- 1" height adjustment increments
- Tamper resistant, dual height adjustment system

DESKS & TABLES

C-LEG

C-Leg desks provide a minimal base with swing out leg room, ideal for compressed classroom spaces.

FIXED HEIGHT

- 29" high

ADJUSTABLE HEIGHT

- 24"-32" high
- 29"-42" high
- 1" height adjustment increments
- Tamper resistant, dual height adjustment system

WORKSURFACE

- 1" thick worksurfaces
- HPL (standard)
- Rectangle shape with square corners
- Plane shape with rounded corners

MOBILITY

- 2" diameter levelers
- 75mm casters - locking

FRAME AND LEGS

- Fully welded
- Square tube legs
- Rectangle crossbar
- Rectangle base
- Bag hook accessory attaches to bar
- See ADJUSTABLE HEIGHT for other features
- Two student desk includes under desk storage box with center divider. Factory installed.

SHIPPING

- Worksurfaces ship stacked, separate from frame/leg assembly
- Frames ship nested
- Levelers or casters installed
- Height adjustment tools included if needed
- Two student desk ships fully assembled with under desk storage box installed.



SPACE BETWEEN LEGS

Worksurface	Distance Between
Width	A
27"	22.44"
54"	49.44"

DESKS & TABLES

C-LEG - COMPUTER

Accommodate large digital displays and CPUs by routing cords through the rugged steel wire management box at the back of this table, which flips up for easy access.

Other computer tables are available.

FIXED HEIGHT

- 29" high

WORKSURFACE

- 1" thick worksurfaces
- HPL (standard)
- Square corners on back and access door
- Rounded corners on front, 2" radius

MOBILITY

- 1.5" diameter levelers - all legs
- 75mm casters - all locking

FRAME AND LEGS

- Fully welded
- Square tube legs
- Rectangle crossbar
- Rectangle base
- Bag hook accessory attaches to bar

ADDITIONAL FEATURES

- Steel wire management tray
- Flip top access to wire management box square corners

SHIPPING

- Ships assembled
- Levelers or casters installed

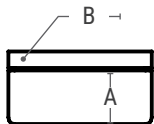

A

SPACE BETWEEN LEGS

Worksurface	Distance Between Legs
Width	A
36"	32"
48"	44"
60"	56"
72"	68"

Worksurface		
Depth	A	B
24"	17.75"	5.63"
30"	23.75"	5.63"



DESKS & TABLES

I-LEG

This alternative to traditional four-leg tables supports different aesthetic and functional needs while increasing knee swing area under the worksurface.

FIXED HEIGHT

- 29" high - No foot rail

ADJUSTABLE HEIGHT

- 21"-28" - No foot rail
- 25"-32" - No foot rail
- 29"-42" - No foot rail
- 34"-42" - With foot rail
- 1" height adjustment increments
- Tamper resistant, dual height adjustment system

WORKSURFACE

- 1" thick worksurfaces
- HPL (standard)
- Rectangle shape with square corners
- Other shapes with rounded corners

MOBILITY

- 2" diameter levelers
- 75mm casters, locking

FRAME AND LEGS

- Fully welded
- Square tube legs
- Rectangle crossbar
- Rectangle tube base
- Bag hook accessory attaches to bar
- Foot rail with 34-42" adjustable height range

SHIPPING

- Unit ships ready to assemble.
- Frame assembled and levelers or casters installed

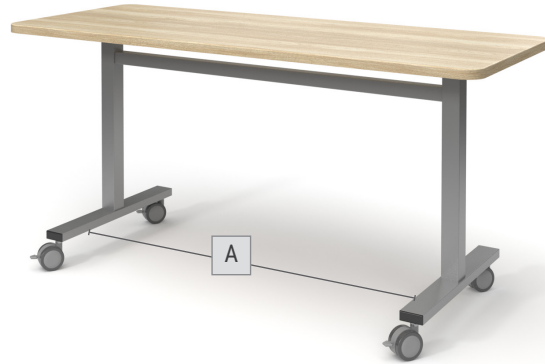

SPACE BETWEEN LEGS

Worksurface	Distance Between Legs
Width	A
48"	32"
54"	38"
60"	44"
72"	44"

DESKS & TABLES

FLIP & NEST

Give teachers the flexibility to move tables in and out of active use as needed. Pull up on the recessed activation bar to flip worksurfaces up and roll them out of the way – or use them for vertical display.

FIXED HEIGHT

- 29" high - No foot rail

ADJUSTABLE HEIGHT

- 21"-28" - No foot rail
- 25"-32" - No foot rail
- 29"-42" - No foot rail
- 34"-42" - With foot rail
- 1" height adjustment increments
- Tamper resistant, dual height adjustment system

WORKSURFACE

- 1" thick worksurfaces
- HPL (standard)
- Rectangle shape with square corners
- Other shapes have rounded corners

MOBILITY

- 75mm casters - locking - all legs

FRAME AND LEGS

- Fully welded
- Square tube legs
- Rectangle crossbar
- Rectangle tube base
- Activation bar and mechanism integrated into frame

ADDITIONAL FEATURES

- Standard frame inset is 4"
- 72" wide tables have a 10" inset
- Activation bar

SHIPPING

- Unit ships assembled



TABLE HEIGHT IN FLIPPED UP POSITION

Table Height	Worksurface depth			
	20"	24"	27"	30"
29"	37.5"	39.5"	41"	42.5"
21-28"	29.5-36.5"	31.5-38.5"	33-40"	-
25-32"	33.5-40.5"	35.5-42.5"	37-44"	38.5-45.5"
29-42"	37.5-50.5"	39.5-52.5"	41-54"	42.5-55.5"
34-42"	42.5-50.5"	52.5-52.5"	46-54"	47.5-55.5"

SPACE BETWEEN LEGS

Worksurface Width	Distance Between
	A
48"	31.5"
54"	37.5"
60"	43.5"
72"	43.5"

DESKS & TABLES

STACKER

Classrooms need tables, but experiential learning also requires open areas. You can achieve both goals with these fully welded steel-leg tables, which stack up to three high.

FIXED HEIGHT

- 29" high

ADJUSTABLE HEIGHT

- 24"-32"
- 1" height increments
- Tamper resistant, dual height adjustment system
- No visible adjustment holes

WORKSURFACE

- 1" thick worksurfaces
- HPL (standard)

MOBILITY

- 1.5" diameter on all levelers - all legs
- Wheelbarrow - 75mm casters and 1.5" diameter leveler combination
- 75mm casters - all legs

FRAME AND LEGS

- Fully welded
- Perimeter rectangle tubular frame under perimeter of worksurface.
- Perimeter frame not on worksurface front
- Rounded tube legs
- See ADJUSTABLE HEIGHT for other features

ADDITIONAL FEATURES

- Protective worksurface bumpers

SHIPPING

- Worksurfaces ship stacked, separate from frames
- Frames ship stacked
- Levelers or caster stems installed on legs
- Casters field installed

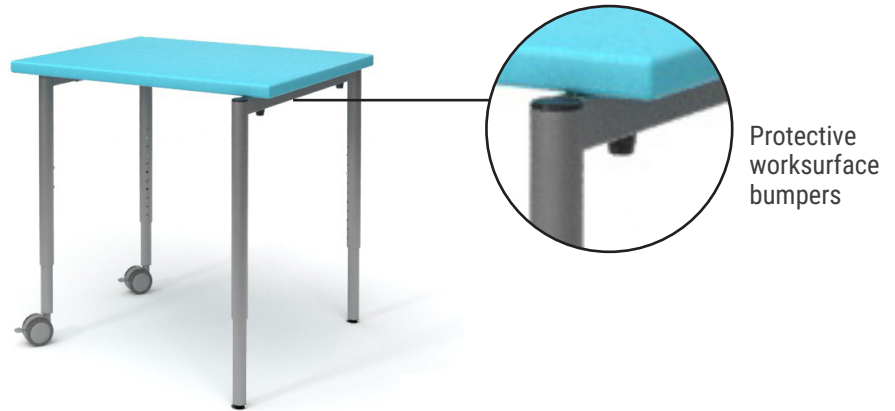

Protective worksurface bumpers



SPACE BETWEEN LEGS

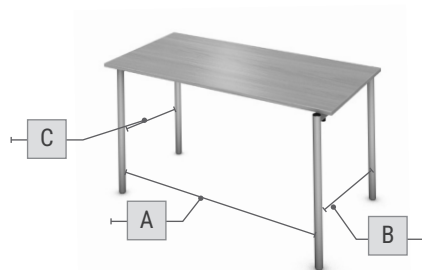

Worksurface		Distance Between		
Width	Depth	A	B	C
30"-32"	24"	23.25"	24"	17.25"
54"	27"	47.25"	27.25"	20.25"

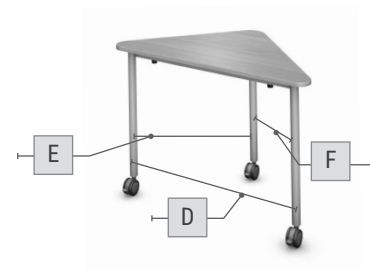

Worksurface		Distance Between		
Width	Depth	D	E	F
41"	22"	33.5"	23.25"	23.25"

DESKS & TABLES

PNEUMATIC BASE

Promote healthy movement by enabling teachers and students to alternate between sitting, perching or standing throughout the day. An easy-to-operate handle underneath the worksurface adjusts height.

ADJUSTABLE HEIGHT

- Single column on casters: 28"-45"
- Double column on levelers: 28"-48"
- Double column on casters: 31"-51"

WORKSURFACE

- 1" thick worksurfaces
- HPL (standard)
- Rectangle shape with square corners
- Other shapes with rounded corners

MOBILITY

- Levelers - double column only
- 75mm casters - single & double column
- 3"H increase on castered double column

FRAME AND LEGS

- 3-part pneumatic column with flat top plate
- Non-stepped adjustability
- Rectangle base
- Silver paint only
- 35lb. capacity when in motion
- 400lb. capacity when in fixed position
- Desk storage box is factory installed.

ADDITIONAL FEATURES

- Under worksurface mounted handle to adjust height of worksurface

SHIPPING

- Table ships assembled with casters or levelers installed

SPACE BETWEEN LEGS

Worksurface	Distance Between
Width	A
30"	22"
60"	44"



DESKS & TABLES

POST LEG

Integrate organic worksurface shapes, larger tops, and unique configurations into your space. Fully welded post legs have a large thick-gauge steel plate positioned to help ensure strength and stability. Custom shapes available.

FIXED HEIGHT

- 14" high
- 29" high

ADJUSTABLE HEIGHT

- 20"-28"
- 24"-32"
- 1" height adjustment increments
- Tamper resistant, dual height adjustment system

WORKSURFACE

- 1" thick worksurface HPL
- Rounded corners 2" radius

MOBILITY

- 1.5" diameter levelers
- 75mm casters - locking

LEGS

- Round tube legs with rectangle top plate
- See ADJUSTABLE HEIGHT for other features

SHIPPING

- Worksurfaces ship stacked, separate from legs
- Legs are bulk packed
- Levelers or casters installed



DESKS & TABLES

PEDESTAL BASE

The heavy steel pedestal base eliminates under-worksurface barriers and supports the organic gathering of students. The clean aesthetic declutters the visual landscape.

FIXED HEIGHT

- 18", 20", 29", 36", or 40" high

WORKSURFACE

- 1" thick worksurfaces
- HPL (standard)

BASE

- 4" diameter column with round flat top plate
- 27" diameter disc base
- A** Glides under disc base

SHIPPING

- Worksurface ships stacked separate from base
- Glides installed



SPACE BETWEEN LEGS

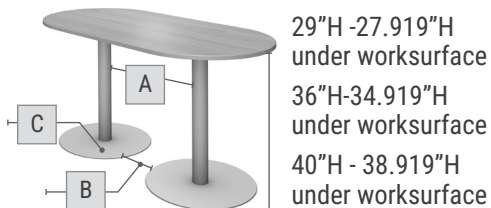

WORKSURFACE SHAPE INNER AND OUTER DIMENSIONS

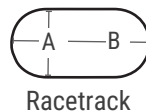

Worksurface		Key Dimensions		Base Plate Diameter
Width	Depth	A	B	C
72"	36"	31.75"	8.75"	27"
84"	42"	37.75"	14.75"	27"
96"	48"	43.75"	20.75"	27"

Depth	A	B	Radius
36"	35.75"	71.75"	18"
42"	41.75"	83.75"	21"
48"	47.75"	95.75"	24"

DESKS & TABLES

PEDESTAL BASE & POST LEG

D-shaped tops flush easily up to walls to provide space for team collaboration, and the flat end is ideal for placing a monitor. Two tables can be quickly joined to double group size.

FIXED HEIGHT

- 29", 36", or 40" high

WORKSURFACE

- 1" thick worksurfaces
- HPL (standard)
- 2" radius corners on flat end

BASE

- 4" diameter column with round top plate
- 27" diameter disc base
- A** Glides under column disc base
- 2" diameter post legs with square top plate
- 2" diameter levelers on post legs

SHIPPING

- Worksurfaces ship stacked, separate from base
- Glides installed



WORKSURFACE SHAPE INNER AND OUTER DIMENSIONS

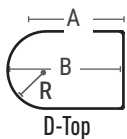

Width	Depth	A	B	R
42"	60"	39"	60"	21"
48"	72"	51"	72"	24"

SPACE BETWEEN LEGS

Worksurface		Key Dimensions		
Width	Depth	A	B	C
42"	60"	33.8"	33.2"	11.5"
48"	72"	39.8"	46.5"	11.5"

DESKS & TABLES

PICNIC TABLE & BENCH

Bring the outside in with this variation of an outdoor picnic table. The familiar vibe is designed to help students connect more informally in classrooms or common areas.

FIXED HEIGHT

- Table: 24", 29"
- Bench: 14", 18"

WORKSURFACE AND BENCH

- 1" thick worksurfaces
- HPL (standard)
- Rectangle shape with square corners

MOBILITY

- 1.5" diameter levelers

FRAME

- Fully welded
- Rectangle tubular frame under perimeter of worksurface.
- Perimeter frame is 4-sided on tops 36"-72" wide
- Square tube legs for rectangle tops

LEGS

- Square

SHIPPING

- Worksurfaces ship stacked, separate from frame/leg assembly, unless table is specified assembled
- Frame/leg assemblies ship stacked, unless tables is specified assembled
- Levelers installed on legs

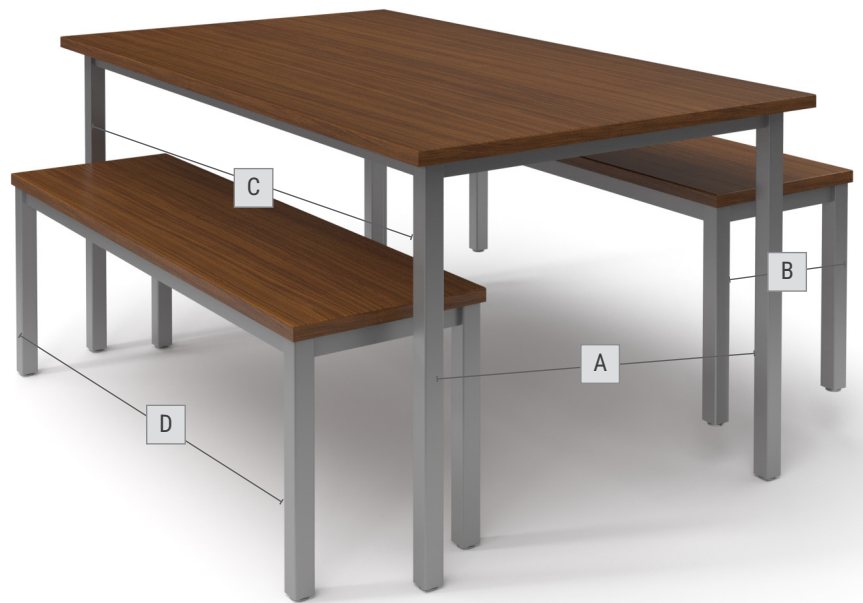

DIMENSIONS

Worksurface Dimensions				
Depth	Width			
	51"	60"	63"	72"
15"	•		•	
30"		•		
36"		•		•

SPACE BETWEEN LEGS

Worksurface			Space Between Legs			
Width	Depth	Bench Seat Width	A	B	C	D
60"	30"	51"	23.69"	11.69"	53.69"	47.69"
60"	36"	51"	29.69"	11.69"	53.69"	47.69"
72"	36"	63"	29.69"	11.69"	65.69"	59.69"

DESKS & TABLES

CARREL

High side and back panels maximize privacy for studying and test-taking, whether seated or standing. Grommets and wire management trays provide power and data routing. In contrast, lower side and back panels create division without compromising openness.

FIXED HEIGHT STARTER UNIT

- 38", 48" high starter shown
- Starters may be used independently

FIXED ADDER UNIT

- 38", 48" high starter shown
- Adder cannot stand alone

WORKSURFACE AND SHELF

- 1" thick HPL worksurface and shelf
- 29" high worksurface

END PANELS

- 1" thick TFL only
- Starters have 2 end panels
- Adders have 1 end panel

ADDITIONAL FEATURES

- A** 2.5" diameter grommets (end panels and worksurface)
Back access
- B** Steel wire management tray under worksurface (black)

SHIPPING

- Starter and adder carrels ship unassembled.
- Panels shipped stacked together

STARTER UNIT



ADDER UNIT

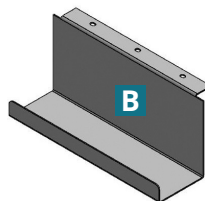

DIMENSIONS

	Worksurface Dimensions		
	Depth	Width	Width
Overall	30"	35"	36"
Between Legs A		34"	34"

DESKS & TABLES

FULL END PANEL

Available in two heights, these tables support sitting, perching, or standing. The narrow options create cozy touchdown spots against walls or windows, while the wider tops invite gathering in open spaces.

FIXED HEIGHT

- 30"
- 36"

WORKSURFACE

- 1" thick worksurfaces
- HPL (standard)
- Rectangle only

MOBILITY

- 1" diameter levelers

SUPPORT

- 1" thick TFL body panels and modesty panel

MODESTY PANEL FEATURES

- TFL
- Full height, off-set modesty panel (29" high)
- 14" high modesty panel
 - 14" above the floor on 29" high tables
 - 21" above the floor on 36" high tables
- Modesty panel is centered on all depths except 20" where it is flush to the back.

SHIPPING

- Table ships unassembled



DIMENSIONS

Worksurface Dimensions			
Depth	Width		
		60"	72"
20"	.	.	.
36"	.	.	.
42"	.	.	.

SPACE BETWEEN LEGS

Worksurface	Distance Between legs
Width	A
60"	57.72"
72"	69.72"
84"	81.72"

DESKS & TABLES

TEACHER DESK

A traditional desking solution available in multiple configurations to meet different space and function requirements. Ample below-the-surface pedestal storage helps keep the desktop clean for teachers, school staff, and students.

FIXED HEIGHT

- 29" high - D-top

DESK & L-TOP ASSEMBLY

- 30" high - Desk & L-top assembly

WORKSURFACE

- 1" thick worksurface
- HPL (standard)
- Rounded corners; 2" radius

DRAWERS AND PULLS

- Steel drawer bodies. Full extension slides
- Keyed-alike cylinder locks
- 96mm Arch pull

CASE

- 3/4" thick TFL body and modesty panels
- Steel base frame

MOBILITY

- Levelers
- 75mm casters

LEGS

- Tubular steel fixed-height C-Leg on D-Top
- Short metal legs with levelers attached to perimeter frame on non-mobile solution

ADDITIONAL FEATURES

- A** 2.5" grommet in black
- B** Wire management tray in back
- C** Connecting hardware
- D** C-leg fixed height
- E** Legs with levelers
- F** 75mm Casters

SHIPPING

- D-top and desk ship assembled
- L-top configuration ships as subassemblies with connecting hardware included

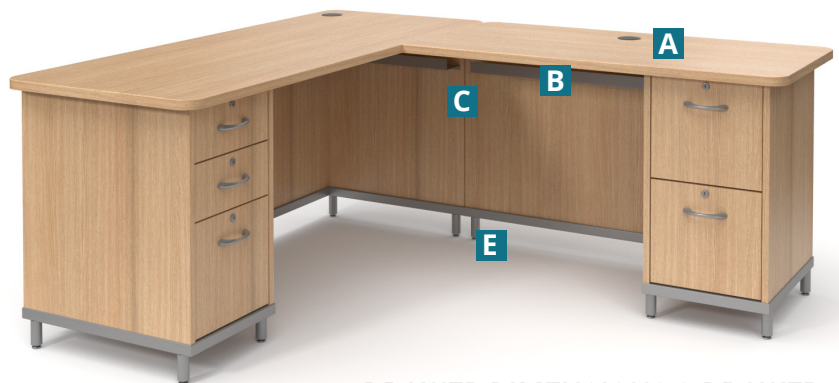
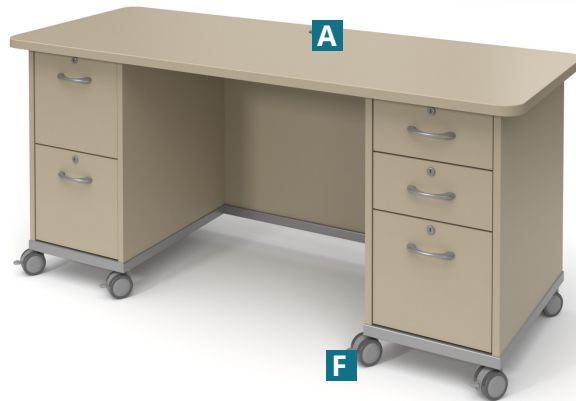
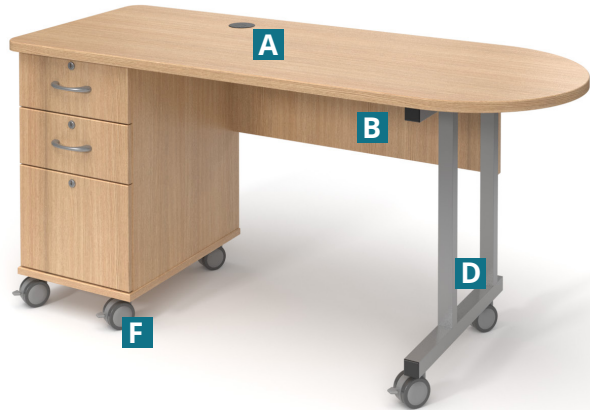

DRAWER DIMENSIONS & DRAWER WEIGHT CAPACITY

	Box Drawer	File Drawer
	Inside	Inside
Width	12.12"	12.12"
Depth	16.25"	16.25"
Height	4"	9.5"
Weight capacity per tray (pounds)	30 lbs.	30 lbs.

DESKS & TABLES
TEACHER DESK

SINGLE PED, C-LEG

Worksurface		Distance Between	
Width	Depth	A	B
60"	24"	31"	24"
60"	30"	31"	30"

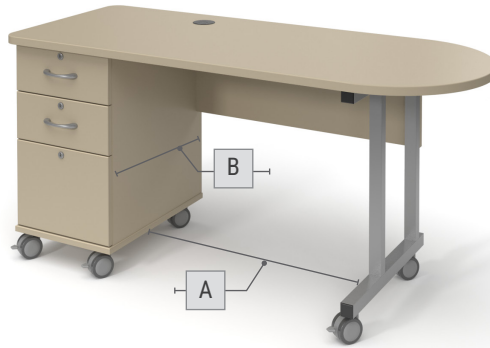

SINGLE PED, FULL END PANEL

Worksurface		Distance Between	
Width	Depth	A	B
48"	26"	27.875"	22.5"
66"	26"	45.875"	22.5"



DOUBLE PED, FULL END PANEL

Worksurface		Distance Between	
Width	Depth	A	B
66"	26"	31.875"	22.5"



DESKS & TABLES

TRANSACTION DESK SYSTEM

This desk establishes a welcoming presence while reinforcing appropriate boundaries. Optional transaction counters and storage units add functional space above and below the workspace.

WORKSURFACES

(DESK AND COUNTER)

- 1" thick
- HPL (standard)
- Rectangle, squared corners
- 1.25" high metal support rail under worksurface

CASE

- 1" thick end panels
- 3/4" thick back panels, toe kick, doors and shelves
- TFL only
- Desks and storage feature levelers
- Roll-in storage has concealed casters
- Transaction surfaces are constructed with metal brackets and counters are mounted to the desk with VHB
- Grommets in end panels of desk only. Additional grommets available for field install.

DOORS & PULLS

- Keyed-alike cylinder lock, chrome
- 120° European hinge
- 128mm Arch pull or 128mm Metro or Urban pull

ADDITIONAL FEATURES

- A** Concealed casters
- B** 75 lb. shelf capacity
- C** Built in foot rest and storage stop
- D** 2.5" grommet in each end panel

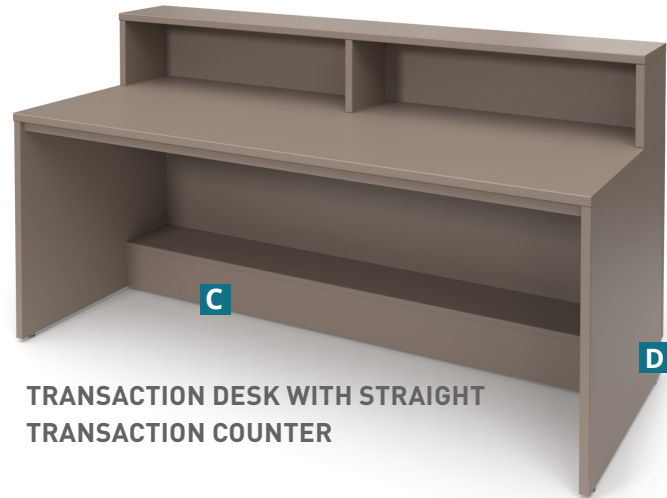

TRANSACTION DESK WITH STRAIGHT TRANSACTION COUNTER

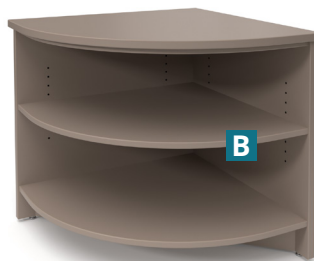

CORNER FILLER



UNDER DESK STORAGE

SHIPPING

- Subassemblies ship assembled
- Final assembly field installed
- Sleeve connectors included

BOOK RETURN

	Outside	Straight
Width	36"	33.875"
Depth	30"	19.875"
Height	29"	26.25"

DRAWER

	Box Inside	File Inside	Lateral Inside
Width	12.12"	12.12"	28.9"
Depth	16.25"	16.25"	16.9"
Height	4"	9.5"	9.3"
Weight Capacity: 30 lbs per drawer			

TRANSACTION DESK

		Inside		
		Outside	Straight	Corner
Width	Roll-in	23"	21.3"	-
	Counter	36"	33.9"	-
	Counter	48"	45.9"	-
	Desk	48"	45.9"	-
	Desk	60"	57.9"	-
	Desk	72"	69.9"	-
Depth	Desk	84"	81.9"	-
	Counter	10"	9"	6.2"
	Roll-in	20"	18"	-
Height	Desk	30"	20"	-
	Counter	29"	26"	-
	Counter	10"	9"	9"
	Roll-in	26"	20"	-
	Desk	29"	26"	-

DESKS & TABLES

WORKSTATION AND WORKSURFACE

WORKSURFACE

- 1" thick laminate and phenolic resin, 1-3/4" thick maple block
- Painted metal front rail
- HPL (standard)
- HPL G5
- Chemical resistant HPL
- Phenolic resin
- Maple block

DOORS, PULLS

- Keyed-alike cylinder lock
- 128mm Arch, Metro or Urban pull
- Soft-close 120° European hinge

CASE

- 3/4" thick vertical and horizontal panels
- TFL only
- Bottom panel can act as shelf and is not included in shelf count.

SHELVES

- 3/4" thick
- TFL only
- Adjustable, 32mm increments
- 35lb. capacity

MOBILITY

- 100mm locking casters

SHIPPING

- Units ship assembled with casters attached
- Worksurfaces ship unattached in separate packaging
- Pulls attached to door (if applicable)

DIMENSIONS

	Cabinet Base	
	Outside	Inside
Width	48"	46.5"
Depth	24"	22"
Height	37"	28.5"

	18 Cubby
Width	14.75"
Depth	11"
Height	8.25"



Two Workstations locked with worksurface connectors.

OPTIONAL WORKSURFACE CONNECTORS FOR WORKSTATIONS

Field installation required.

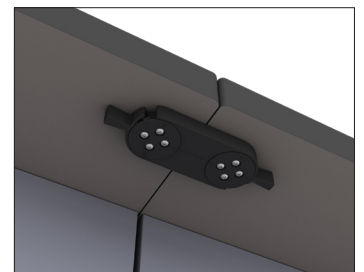
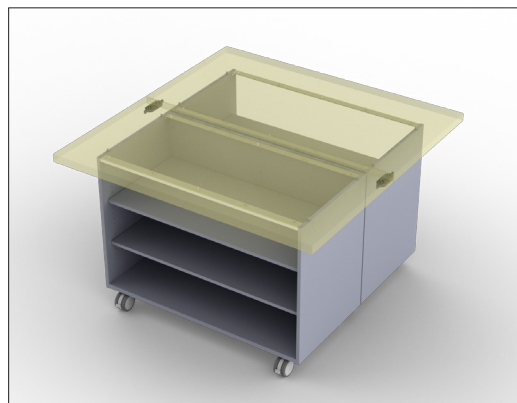

WORKSURFACE CONNECTOR
Model Number: MSL99 List: \$46
 Includes installation instructions.

DESKS & TABLES

CRANK HEIGHT ADJUSTABLE

Give students the power to gain new leverage or perspective on their projects through vertical table movement. Table legs and worksurfaces are engineered to support heavy weight.

ADJUSTABLE HEIGHT

- 27"-38.5" for 1" thick worksurface
- 1.75" thick maple block worksurface adds 0.75" to height ranges.

WORKSURFACE

- 1" thick worksurfaces
- HPL (standard)
- Chemical Resistant HPL
- Phenolic Resin
- Solid Maple Block (1-3/4" thick)

MOBILITY

- 2" diameter levelers - all legs

FRAME AND LEGS

- 11.5" height adjustable legs
- Tubular base
- Metal modesty panel. Color matched to legs

ADDITIONAL FEATURES

- A** Crank handle with slip clutch
- B** Anodized finish on upright
- C** Painted finish on foot

SHIPPING

- Ships assembled
- Levelers installed

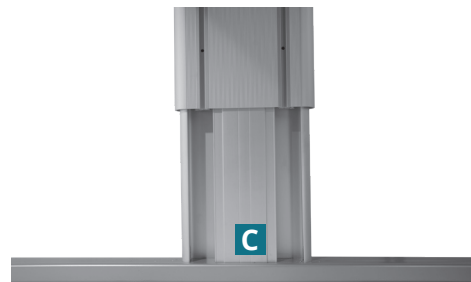
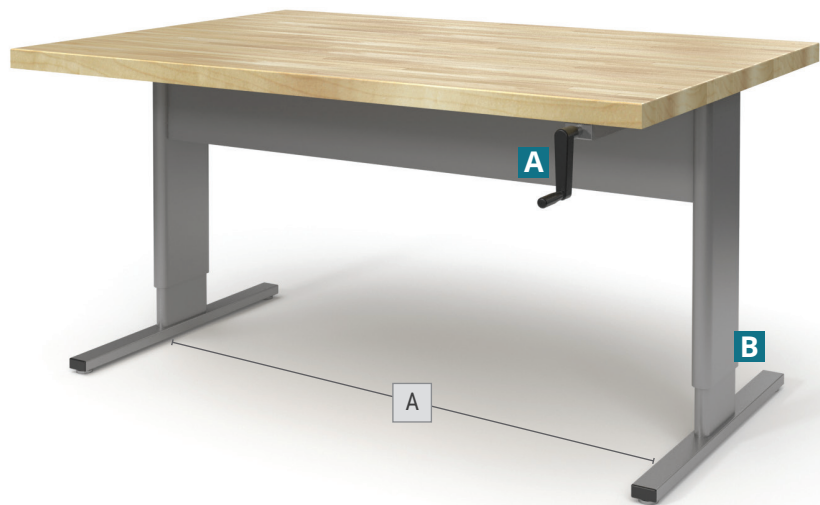

SPACE BETWEEN LEGS

Worksurface	Distance Between
Width	A
60"	51"

DESKS & TABLES

WOOD LEG

The classic wood-frame science table is available in a wide range of sizes.

FIXED HEIGHT

30", 36"

WORKSURFACE

- 1" thick worksurfaces
- HPL (standard)
- HPL Specialty
- Phenolic Resin
- Rectangle shape with square corners

BASE

- Light-colored wood, clear coat

MOBILITY

- 1.5" diameter levelers - all legs

SHIPPING

- Ships partially assembled
- Levelers installed
- Apron frame attached to worksurface
- Field installed legs

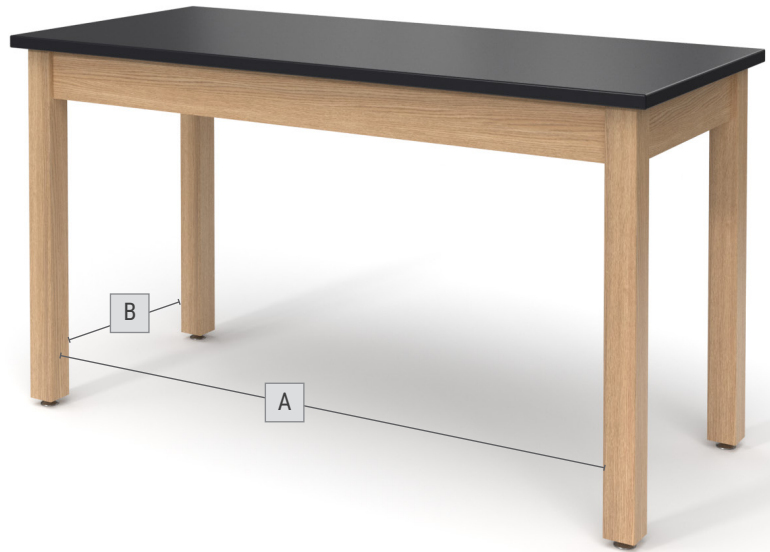

SPACE BETWEEN LEGS

Worksurface		Distance Between legs	
Width	Depth	A	B
48"	24"	41.5"	17.5"
48"	30"	41.5"	23.5"
48"	36"	41.5"	29.5"
48"	48"	41.5"	41.5"
54"	24"	47.5"	17.5"
54"	27"	47.5"	20.5"
54"	30"	47.5"	23.5"
54"	36"	47.5"	29.5"
60"	24"	53.5"	17.5"
60"	30"	53.5"	23.5"
60"	36"	53.5"	29.5"
60"	42"	53.5"	35.5"
72"	24"	65.5"	17.5"
72"	30"	65.5"	23.5"
72"	36"	65.5"	29.5"
72"	42"	65.5"	35.5"



LEG PROTECTOR BOOT

(set of 4)
 Model#: 703700
 List Price \$19
 Field installed